

VARIOCON

Modular Contact Inserts

1. Short Description

The modular contact inserts are based on the tried-and-tested COMBICON technology. They are available with the screw connection system and on the equipment side also as a solder in version.

The sleeve or mounting contact inserts are snapped into the correct frames and are then simple to assemble and mount. The modules are easy to unsnap with a screwdriver.

All contact inserts can be equipped with coding profiles. This rules out the possibility of mixing up several plug connectors.

The modules can be individually labeled using the corresponding marker cards SK...

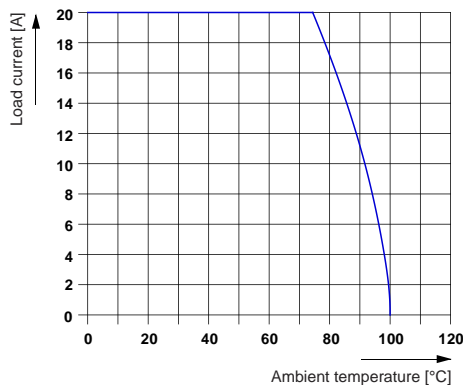

Derating curve VC-TFS 2 / VC-AML 2 / VC-AMS 2

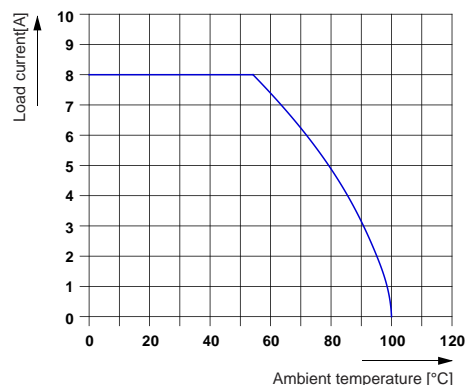

Derating curve VC-TFS HC 8 / VC-AML 8 / VC-AMS 8

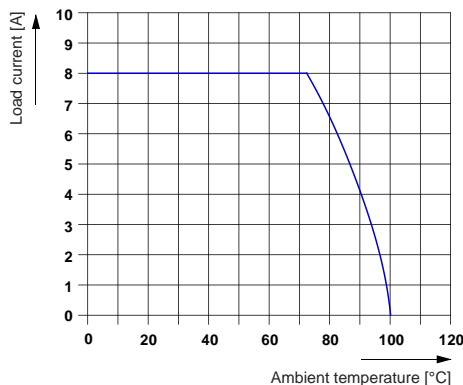

Derating curve VC-TFS HC 6 / VC-AML 6 / VC-AMS 6

VARIOCON

Sleeve Contact Insert with Screw Terminal Blocks



Description	Number of positions	Type	Order No.	Pcs./Pkt.
Contact insert , for sleeve frames	2	VC-TFS 2	18 52 84 6	10
	6	VC-TFS 6	18 53 47 6	
	8	VC-TFS 8	18 52 82 0	
Accessories				
Coding section , for VC-...2, is inserted into the groove on the connector and header, red insulating material		CP-HCC 4	16 00 02 7	100
Coding section , for VC-...6/8, is inserted into the groove on the header, red insulating material		CP-MSTB	17 34 63 4	100

Technical data

Design

Technical data in accordance with IEC/ DIN VDE

		VC-TFS 2	VC-TFS 6	VC-TFS 8
Rated current	[A]	20	8	8
Rated voltage	[V]	400	250	160
Surge voltage category / contamination class		III / 3	III / 3	III / 3
Rated surge voltage / insulation material group	[kV] / -	6 / I	4 / I	2.5 / I
Connection capacity				
Solid / Stranded	[mm ²] / [mm ²]	0.2 - 4.0 / 0.2 - 1.5	0.14 - 1.5 / 0.14 - 1.5	0.14 - 1.5 / 0.14 - 1.5
	AWG / AWG	24 - 12 / 24 - 16	28 - 16 / 28 - 16	28 - 16 / 28 - 16
Multiple connection (2 conductors with same cross section)				
Solid / Stranded	[mm ²] / [mm ²]	0.2 - 2.5 / 0.2 - 1.5	0.14 - 0.5 / 0.14 - 0.75	0.14 - 0.5 / 0.14 - 0.75
	AWG / AWG	24 - 14 / 24 - 16	28 - 20 / 28 - 18	28 - 20 / 28 - 18
Stranded with ferrule without plastic sleeve	[mm ²] / [mm ²]	0.25 - 1.5	0.25 - 0.34	0.25 - 0.34
	AWG / AWG	24 - 16	24 - 20	24 - 20
Stranded with TWIN ferrule with plastic sleeve	[mm ²] / [mm ²]	0.5 - 2.5	0.5	0.5
	AWG / AWG	20 - 14	20	20
Insulating material				
Inflammability class in acc. with UL 94		PA	PA	PA
		V0	V0	V0
Approval data (UL and CUL)				
Nom. voltage / nom. current / conduc. cross sec.	UL: [V] / [A] / AWG	600 / 20 / 30-10	300 / 8 / 30-14	300 / 8 / 30-14
	CUL: [V] / [A] / AWG	600 / 20 / 30-10	300 / 8 / 30-14	300 / 8 / 30-14
Torque	[Nm]	0.5 - 0.6	0.22 - 0.25	0.22 - 0.25
Approvals				

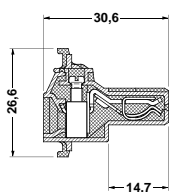

VC-TFS 2

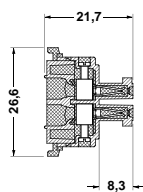
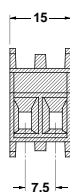

VC-TFS 6

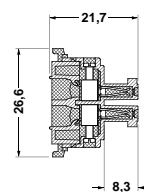

VC-TFS 8

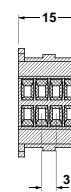

VARIOCON

Mounting Contact Insert with Screw Terminal Blocks



Description	Number of positions	Type	Order No.	Pcs./Pkt.
Contact insert , for panel mounting frames	2	VC-AMS 2	18 53 52 8	10
	6	VC-AMS 6	18 54 01 9	
	8	VC-AMS 8	18 54 02 2	
Accessories				
Coding section , for VC-...2, is inserted into the groove on the connector and header, red insulating material		CP-HCC 4	16 00 02 7	100
Coding section , for VC-...6/8, is inserted into the groove on the header, red insulating material		CP-MSTB	17 34 63 4	100

Technical data

Design

Technical data in accordance with IEC/ DIN VDE

		VC-AMS 2	VC-AMS 6	VC-AMS 8
Rated current	[A]	20	8	8
Rated voltage	[V]	400	250	160
Surge voltage category / contamination class		III / 3	III / 3	III / 3
Rated surge voltage / insulation material group	[kV] / -	6 / I	4 / I	2.5 / I
Connection capacity				
Solid / Stranded	[mm ²] / [mm ²]	0.2 - 4.0 / 0.2 - 1.5	0.14 - 1.5 / 0.14 - 1.5	0.14 - 1.5 / 0.14 - 1.5
	AWG / AWG	24 - 12 / 24 - 16	28 - 16 / 28 - 16	28 - 16 / 28 - 16
Multiple connection (2 conductors with same cross section)				
Solid / Stranded	[mm ²] / [mm ²]	0.2 - 2.5 / 0.2 - 1.5	0.14 - 0.5 / 0.14 - 0.75	0.14 - 0.5 / 0.14 - 0.75
	AWG / AWG	24 - 14 / 24 - 16	28 - 20 / 28 - 18	28 - 20 / 28 - 18
Stranded with ferrule without plastic sleeve	[mm ²] / [mm ²]	0.25 - 1.5	0.25 - 0.34	0.25 - 0.34
	AWG / AWG	24 - 16	24 - 20	24 - 20
Stranded with TWIN ferrule with plastic sleeve	[mm ²] / [mm ²]	0.5 - 2.5	0.5	0.5
	AWG / AWG	20 - 14	20	20
Insulating material				
Inflammability class in acc. with UL 94		PA	PA	PA
		V0	V0	V0
Approval data (UL and CUL)				
Nom. voltage / nom. current / conduc. cross sec.	UL: [V] / [A] / AWG	600 / 20 / 30-10	300 / 8 / 30-14	300 / 8 / 30-14
	CUL: [V] / [A] / AWG	600 / 20 / 30-10	300 / 8 / 30-14	300 / 8 / 30-14
Torque	[Nm]	0.5 - 0.6	0.22 - 0.25	0.22 - 0.25
Approvals				

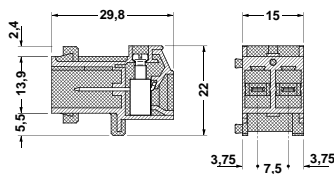

VC-AMS 2

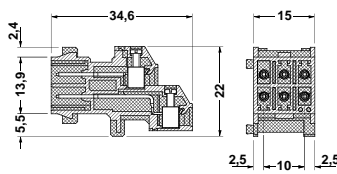

VC-AMS 6

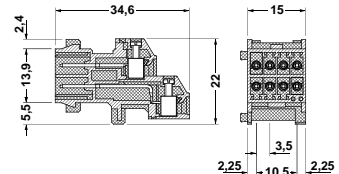

VC-AMS 8

VARIOCON

Mounting Contact Insert with 90° Angled Solder-In Pins

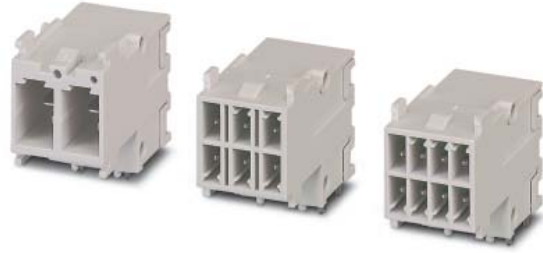

Description	Number of positions	Type	Order No.	Pcs./Pkt.
Contact insert , for mounting panel frames	2	VC-AML 2	18 52 85 9	10
	6	VC-AML 6	18 53 53 1	
	8	VC-AML 8	18 52 83 3	
Accessories				
Coding section , for VC-...2, is inserted into the groove on the connector and header, red insulating material		CP-HCC 4	16 00 02 7	100
Coding section , for VC-...6/8, is inserted into the groove on the header, red insulating material		CP-MSTB	17 34 63 4	100

Technical data

Design		VC-AML 2	VC-AML 6	VC-AML 8
Dimensions solder-in pins	[mm] x [mm]	2 x 0.8	0.8 x 0.8	0.8 x 0.8
Hole diameter	[mm]	1.4	1.4	1.2
Technical data in accordance with IEC/ DIN VDE				
Rated current	[A]	20	8	8
Rated voltage	[V]	400	250	160
Surge voltage category / contamination class		III / 3	III / 3	III / 3
Rated surge voltage / insulation material group	[kV] / -	6 / I	4 / I	2.5 / I
Insulating material		PA	PA	PA
Inflammability class in acc. with UL 94		V0	V0	V0
Approval data (UL and CUL)				
Nom. voltage / nom. current / conduc. cross sec.	UL: [V] / [A] / AWG	600 / 20 / -	300 / 8 / -	300 / 8 / -
	CUL: [V] / [A] / AWG	600 / 20 / -	300 / 8 / -	300 / 8 / -
Approvals				

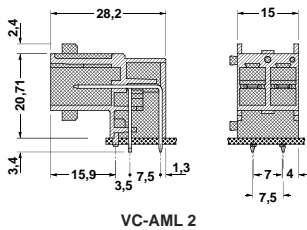

VC-AML 2

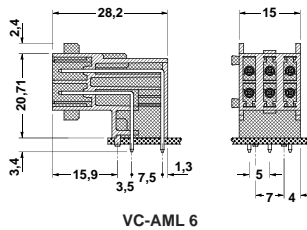

VC-AML 6

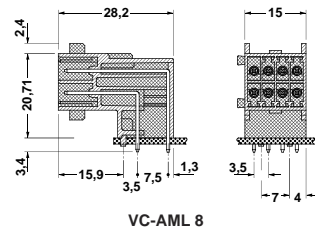

VC-AML 8

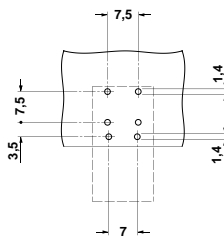

Drilling diagram VC-AML 2

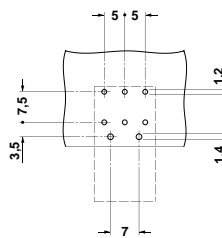

Drilling diagram VC-AML 6

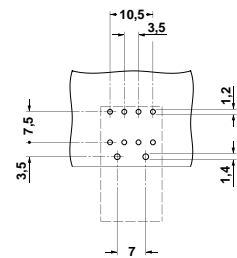

Drilling diagram VC-AML 8

VARIOCON

Mounting Contact Insert with Straight Solder-In Pins



Description	Number of positions	Type	Order No.	Pcs./Pkt.
Contact insert , for panel mounting frames	2	VC-AMLV 2	18 84 97 9	10
	6	VC-AMLV 6	18 84 87 2	
	8	VC-AMLV 8	18 84 88 5	
Accessories				
Coding section , for VC-...2, is inserted into the groove on the connector and header, red insulating material		CP-HCC 4	16 00 02 7	100
Coding section , for VC-...6/8, is inserted into the groove on the header, red insulating material		CP-MSTB	17 34 63 4	100

Technical data

Design		VC-AMLV 2	VC-AMLV 6	VC-AMLV 8
Dimensions solder-in pins	[mm] x [mm]	2 x 0.8	0.8 x 0.8	0.8 x 0.8
Hole diameter	[mm]	1.4	1.4	1.2
Technical data in accordance with IEC/ DIN VDE				
Rated current	[A]	20	8	8
Rated voltage	[V]	400	250	160
Surge voltage category / contamination class ¹⁾		III / 3	III / 3	III / 3
Rated surge voltage / insulation material group	[kV] / -	6 / I	4 / I	2.5 / I
Insulating material		PA	PA	PA
Inflammability class in acc. with UL 94		V0	V0	V0
Approval data (UL and CUL)				
Nom. voltage / nom. current / conduc. cross sec.	UL: [V] / [A] / AWG	600 / 20 / -	300 / 8 / -	300 / 8 / -
	CUL: [V] / [A] / AWG	600 / 20 / -	300 / 8 / -	300 / 8 / -

Approvals

¹⁾ In the 2 and 6-pos. constellation, as well as in the 2 and 8-pos. versions, there is a reduction in the air and creepage distances. The contamination class is thus reduced to 2 and the surge voltage category to II.

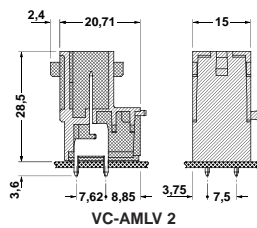

VC-AMLV 2

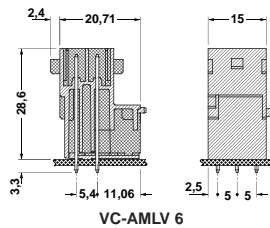

VC-AMLV 6

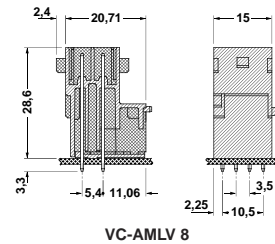

VC-AMLV 8

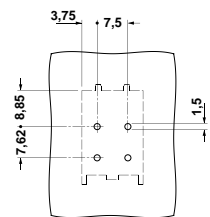

Drilling diagram VC-AMLV 2

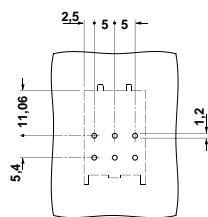

Drilling diagram VC-AMLV 6

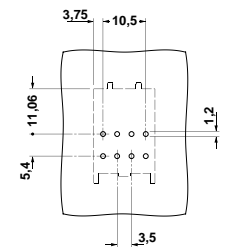

Drilling diagram VC-AMLV 8